

# TECHNICAL DATA SHEET

## INS-INB5900BLK Bath Easy Clean Sprung Waste

<b>Barcode</b>	
<b>Product Code</b>	<b>INS-INB5900BLK</b>
<b>Construction</b>	Zinc Alloy & ABS
<b>Finishes</b>	Matt Black
<b>Product Type</b>	Contemporary
<b>Water Pressure</b>	-
<b>Plumbing Systems</b>	Suitable for all plumbing systems
<b>Standards</b>	-
<b>Certification</b>	-
<b>Fitting</b>	G 1-1/2"
<b>Packaging</b>	58.5x48x42cm/carton (20pcs/carton)
<b>Guarantee</b>	1 years against manufacturing faults (excluding serviceable parts).
<b>Additional Information</b>	Center to center length: 980mm

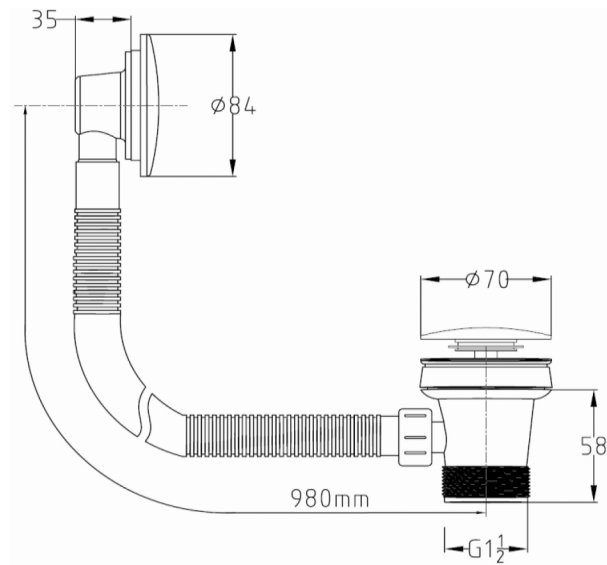

### Flow Rates (Litres per minute)

System Pressure	0.1 Bar	0.2 Bar	0.3 Bar	0.5 Bar	1.0 Bar	1.5 Bar	2.0 Bar	3.0 Bar	4.0 Bar	5.0 Bar
<b>INS-INB5900BLK</b>	-	-	-	-	-	-	-	-	-	-

The information contained on this page was correct at date of issue. Fitting dimensions are provided as a guide only. Some variation may occur due to manufacturing tolerances. We pursue a policy of continuing improvement in design and performance of our products and so reserve the right to change specifications without prior notice.

Exploded Product Drawing

INS-INB5900BLK Bath Easy Clean Sprung Waste

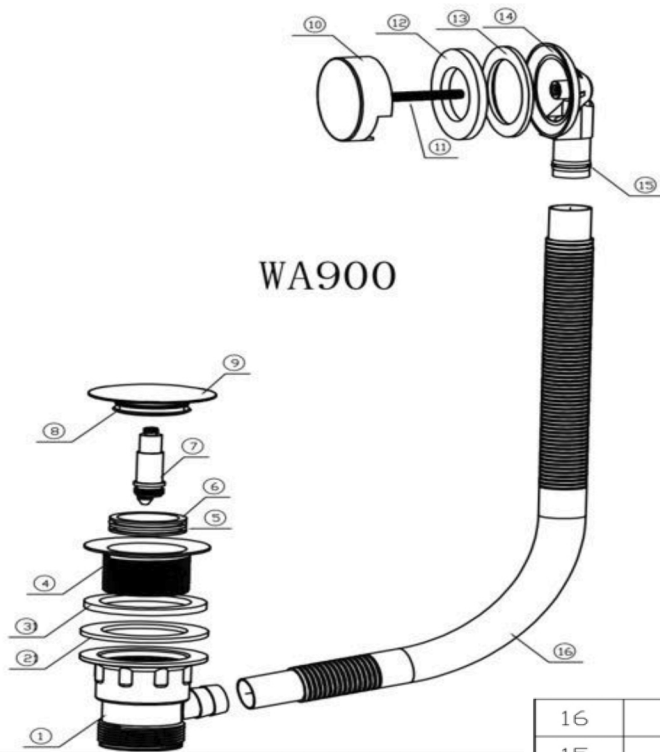

16	plastic pipe	1
15	"O"ring	1
14	overflow elbow	1
13	rubber washer	1
12	foam washer	1
11	stainless steel screw	1
10	overflow cap	1
9	clie cover	1
8	seal ring	1
7	springing core	1
6	springing base	1
5	"O"ring	2
4	flange	1
3	silicon washer	1
2	rubber washer	1
1	plastic body	1
NO	NAME	QTY

Alfred Victoria Exploded Drawings			Material:	Assembly	Size:	A4
		(Date:D/M/Y)	Scale:	None	Issue No:	01
Drawn by:	Sherman	16/05/2016	Issue - Version 1: August 2019			
Checked by:	Lee	16/05/2016				
Approved by:	T. K.	16/05/2016				
Drawing Name:						